

IVR-L 200/24-2 TC DP

IVR-L 200/24-2 Tc Dp AC-powered liquid and swarf vacuum for vacuuming large quantities of oil and swarf. Maintenance-friendly, robust design.



Made in Germany



Order no.

9.989-404.0

- Drum pump function
- Visual filling level indicator

Technical data

EAN code		4054278695143
Supply voltage	Ph / V / Hz	1 / 220 - 240 / 50 - 60
Air flow	l/s / m³/h	148 / 532
Vacuum	mbar / kPa	230 / 23
Container content	l	200
Rated input power	kW	2.4
Vacuuming type		Electric
Connection nominal diameter		ID 50
Accessory nominal diameter		ID 50 / ID 40
Main filter dust class		L
Filter area for main filter	m²	0.45
Weight without accessories	kg	131
Weight (with accessories)	kg	131
Weight incl. packaging	kg	131
Dimensions (L × W × H)	mm	1485 × 760 × 1550

Users must receive training on this device.

Equipment

Drum pump function	■
Container emptying	Tilting chassis
■ Included in the scope of supply.	

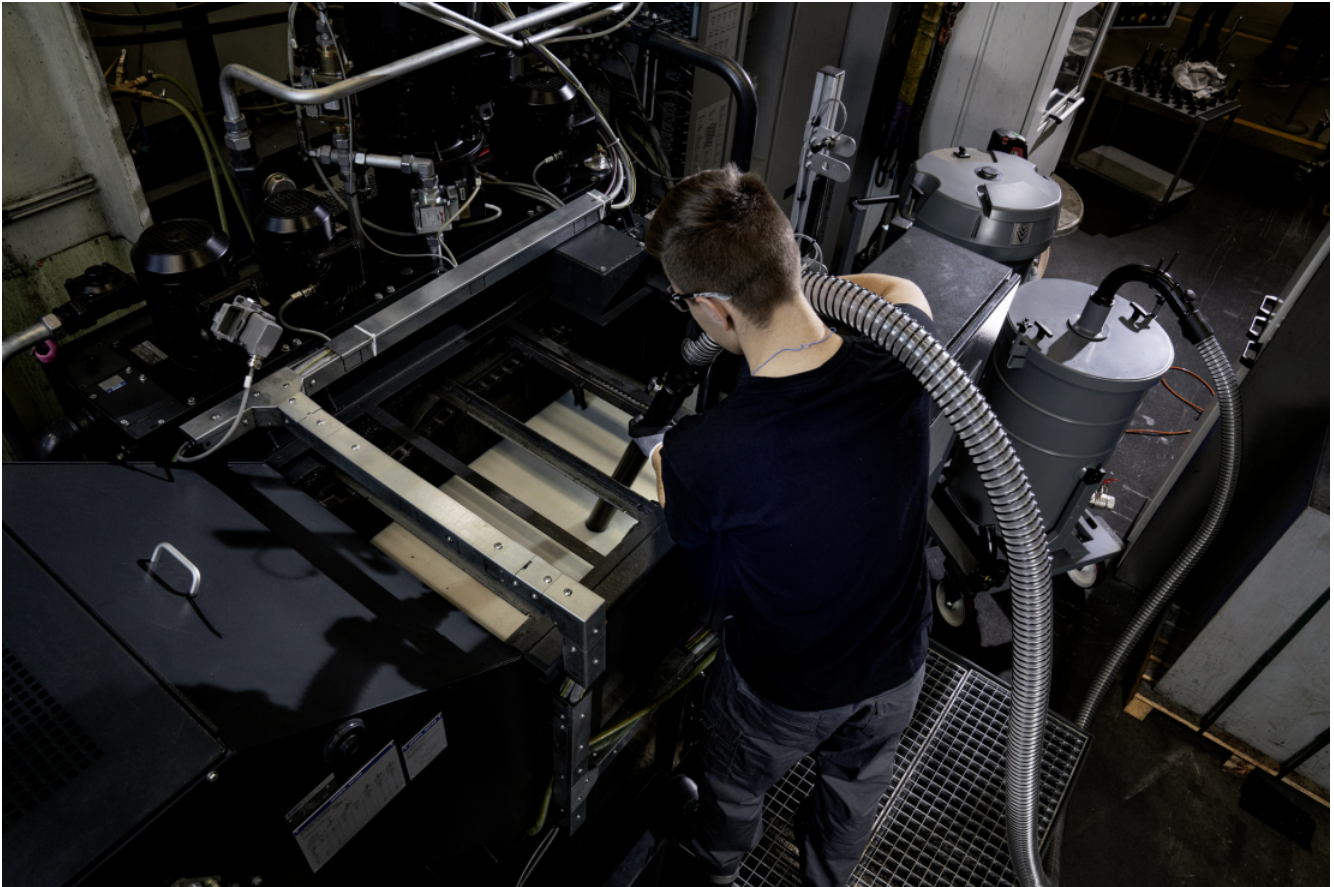

Ergonomic tilting chassis

- Sophisticated system for safe, manual, effortless emptying.
- Chassis system enables ergonomic tilted emptying using the roll-off mechanism.
- Quick and convenient emptying of the large 200-litre containers by tilting.



Drum pump function

- An autonomous barrel pump significantly increases the ability for vacuumed matter to be returned.
- Transparent hose for checking the amount of fluid absorbed.



High robustness, flexibility and modularity

- Machine and chassis very robust and equipped with high wall thicknesses.
- Rotatable hose connection with up to 360° rotatable pipe bend.
- Optionally available with overflow protection, strainer or accessories holder.

ACCESSORIES FOR IVR-L 200/24-2 TC DP

9.989-404.0

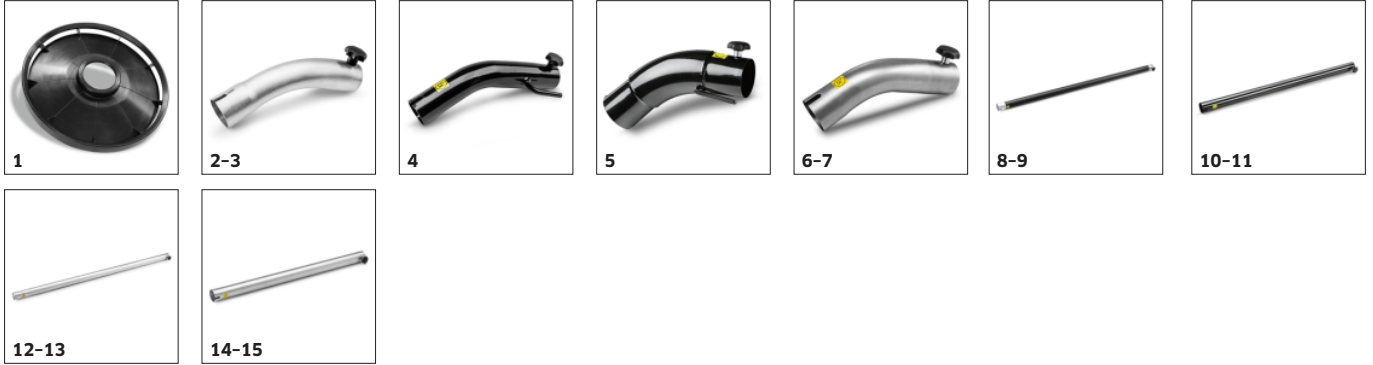

		Order no.	Description	
OTHER ACCESSORIES				
Baffle plate Ø 517 mm	1	9.980-857.0	Baffle plate made from plastic with 517 mm diameter for containers and tanks.	■
HANDLES				
Elbow aluminium 45° DN40	2	9.989-544.0	45° curved handle made from aluminium, DN 40.	<input type="checkbox"/>
Elbow aluminium 45° DN50	3	9.989-547.0	Handle with 45° bend. Made from aluminium, DN 50.	<input type="checkbox"/>
Handle DN 40	4	9.977-679.0	45° curved and electroconductive handle made from stainless steel. Inner cone DN 40.	<input type="checkbox"/>
Handle DN 50	5	9.977-678.0	Electroconductive and 45° curved handle made from stainless steel. Inner cone DN 50.	<input type="checkbox"/>
Stainless steel handle NW40	6	9.989-036.0	Curved and electroconductive handle made from stainless steel. Angle 45°, inner cone NW 40.	<input type="checkbox"/>
Stainless steel handle NW50	7	9.988-111.0	Curved and electroconductive handle made from stainless steel. Angle 45°, inner cone NW 50.	<input type="checkbox"/>
SUCTION TUBES				
Carbon suction tube 1500 mm DN40	8	9.989-552.0	Very light carbon extension tube, electroconductive, DN 40. Length: 1500 mm.	<input type="checkbox"/>
Carbon suction tube 1500 mm DN50	9	9.989-553.0	Electroconductive, very light carbon extension tube. Inner cone DN 50, 1500 mm long.	<input type="checkbox"/>
Suction tube 850 mm DN 40	10	9.977-525.0	Steel extension tube, electroconductive, DN 40. Length: 850 mm.	<input type="checkbox"/>
	11	9.977-531.0	850 mm long extension tube made from steel. Electroconductive and with inner cone DN 50.	<input type="checkbox"/>
Aluminium suction tube 1500 mm NW40	12	9.989-038.0	Aluminium extension tube, electroconductive, NW 40. Length: 1500 mm.	<input type="checkbox"/>
Aluminium suction tube 1500 mm NW50	13	9.989-035.0	Electrically conductive suction tube (1500 mm) made of aluminium with 50 mm diameter.	<input type="checkbox"/>
Stainless steel suction tube 850 mm NW40	14	9.989-039.0	Stainless steel extension tube, electroconductive, NW 40. Length: 850 mm.	<input type="checkbox"/>

■ Included in the scope of supply. Available accessories.

ACCESSORIES FOR IVR-L 200/24-2 TC DP

9.989-404.0



	Order no.	Description	
SUCTION TUBES			
Stainless steel suction tube 850 mm NW50	15 9.988-114.0	Electroconductive extension tube made from stainless steel. Inner cone NW 50.	<input type="checkbox"/>
ACCESSORY SETS			
Accessory kit for liquids			
Liquid accessory kit DN 40	16 9.989-660.0	Accessory kit DN 40 for liquid vacuums: PU hose 3 m (9.989-617.0), handle (9.977-679.0), standard nozzle (9.988-401.0), reducer (9.989-690.0), surface nozzle 120 mm (9.988-118.0).	<input type="checkbox"/>
Liquid accessory kit DN50	17 9.989-661.0	Accessory kit DN 50 for liquid vacuums: PU hose 3 m (9.989-619.0), handle (9.977-678.0), standard nozzle (9.988-402.0), reducer (9.977-772.0), surface nozzle 120 mm (9.988-119.0).	<input type="checkbox"/>
Accessory kit for liquids/chips			
Accessory kit for liquids / sawdust DN40	18 9.989-657.0	Accessory kit DN40 for liquid vacuum and swarf vacuum: 3 m ME-PU hose (9.989-621.0), handle (9.977-679.0), standard nozzle (9.989-674.0), reducer (9.989-690.0), surface nozzle (9.988-118.0).	<input type="checkbox"/>
Accessory kit for liquids/chips DN50	19 9.989-658.0	Accessory kit DN50 for liquid vacuum and swarf vacuum: 3 m ME-PU hose (9.989-623.0), handle (9.977-678.0), standard nozzle (9.989-673.0), reducer (9.977-772.0), surface nozzle (9.988-119.0).	<input type="checkbox"/>
NOZZLES			
Standard nozzles			
Standard PVC nozzle DN40	20 9.989-674.0	Electroconductive standard PVC nozzle. DN 40.	<input type="checkbox"/>
Standard PVC nozzle DN50	21 9.989-673.0	Electroconductive standard PVC nozzle. DN 50.	<input type="checkbox"/>
Standard nozzle silicone DN40	22 9.988-401.0	Stretchy standard nozzle made from silicone, inner cone DN 40.	<input type="checkbox"/>
Standard nozzle silicone DN50	23 9.988-402.0		<input type="checkbox"/>
Standard nozzle cuttable rubber DN40	24 9.989-677.0	Standard nozzle, electroconductive, made from cuttable rubber. DN 40.	<input type="checkbox"/>
Standard nozzle cuttable rubber DN50	25 9.989-675.0	Standard nozzle, electroconductive, made from cuttable rubber. DN 50.	<input type="checkbox"/>
Standard aluminium nozzle DN40	26 9.980-748.0	Diagonal nozzle made from anodised aluminium, electroconductive, DN 40.	<input type="checkbox"/>
Standard aluminium nozzle DN50	27 9.980-749.0	Diagonal nozzle made from anodised aluminium, electroconductive, DN 50.	<input type="checkbox"/>
Flexible standard nozzles			
Standard nozzle flexible PVC DN40	28 9.981-420.0	Electroconductive, flexible round nozzle made from galvanised steel, with rubber mouthpiece DN 30.	<input type="checkbox"/>

■ Included in the scope of supply. □ Available accessories.

ACCESSORIES FOR IVR-L 200/24-2 TC DP

9.989-404.0



29



30-31



32, 35-36



33, 39



34



37-38

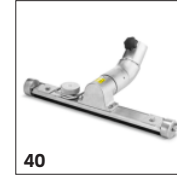

40

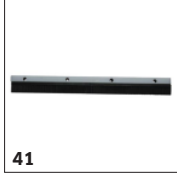

41



42-43

		Order no.	Description	
NOZZLES				
Flexible standard nozzles				
Standard nozzle flexible PVC DN50	29	9.981-421.0	Electroconductive, flexible round nozzle made from galvanised steel, DN 50, with rubber mouthpiece DN 30.	<input type="checkbox"/>
Standard nozzle, flexible, angled 90° PP DN40	30	9.981-429.0	Flexible, electroconductive angled nozzle, DN 40, length: 800 mm.	<input type="checkbox"/>
Standard nozzle, flexible, angled 90° PP DN50	31	9.981-430.0	Flexible, electroconductive angled nozzle, DN 50, length: 800 mm.	<input type="checkbox"/>
Floor nozzles				
Aluminium floor nozzle 370 mm DN40	32	9.989-683.0	Floor nozzle, 370 mm, made from aluminium. DN 40.	<input type="checkbox"/>
Aluminium floor nozzle, el, 370 mm, DN40	33	9.989-682.0	Floor nozzle, 370 mm, made from aluminium. Electroconductive. DN 40.	<input type="checkbox"/>
Aluminium floor nozzle 200 mm DN50	34	9.981-426.0	Floor nozzle, DN 50, with 200 mm suction width.	<input type="checkbox"/>
Aluminium floor nozzle 370 mm DN50	35	9.989-664.0	Floor nozzle. 370 mm, made from aluminium. Electroconductive. DN 50.	<input type="checkbox"/>
Aluminium floor nozzle, el, 370 mm, DN50	36	9.987-612.0	Electroconductive multi-purpose floor nozzle. 370 mm wide, DN 50.	<input type="checkbox"/>
Aluminium floor nozzle 500 mm DN50	37	9.989-684.0	Floor nozzle, 500 mm, made from aluminium. Electroconductive. DN 50.	<input type="checkbox"/>
Aluminium floor nozzle, el, 500 mm, DN50	38	9.981-925.0	Floor nozzle with 500 mm suction width and hinge. DN 50, electroconductive.	<input type="checkbox"/>
Stainless steel floor nozzle el 370 mm DN40	39	9.989-558.0	Multi-purpose floor nozzle (370 mm), electroconductive, DN 40.	<input type="checkbox"/>
Stainless steel floor nozzle el 370 mm DN50	40	9.988-115.0	Floor nozzle (370 mm) made from stainless steel, electroconductive, DN 50.	<input type="checkbox"/>
Floor nozzle rubber strip oil-resistant. 220 mm	41	9.981-923.0	Squeegee with plastic strip for floor nozzle, 220 mm wide.	<input type="checkbox"/>
Floor nozzle rubber strip 370 mm	42	9.981-914.0	Squeegee with profiled strip for floor nozzle, 370 mm wide.	<input type="checkbox"/>

Available accessories.

ACCESSORIES FOR IVR-L 200/24-2 TC DP 9.989-404.0

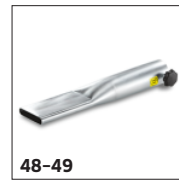
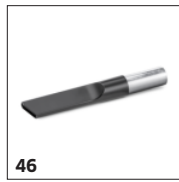
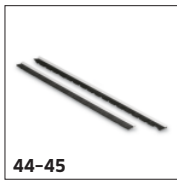

		Order no.	Description	
NOZZLES				
Floor nozzles				
Floor nozzle rubber strip 500 mm	43	9.981-915.0	Oil-resistant squeegee with profiled strip for floor nozzle, 500 mm wide.	<input type="checkbox"/>
Floor nozzle brush strip el. 370 mm	44	9.984-939.0	Electroconductive squeegee for floor nozzle, 370 mm wide.	<input type="checkbox"/>
Floor nozzle brush strip 500 mm	45	9.980-764.0	Brush strip set for floor nozzle 500 mm, with profiled strip.	<input type="checkbox"/>
Crevice nozzles				
Crevice nozzle PP 15 mm × 145 mm DN50	46	9.988-117.0	Electroconductive, flat multi-purpose crevice nozzle made from plastic, DN 52.	<input type="checkbox"/>
Crevice nozzle PU 22 mm × 175 mm DN50	47	9.981-482.0	Crevice nozzle made from PU, DN 50.	<input type="checkbox"/>
Crevice nozzle 18 mm × 120 mm DN50	48	9.981-442.0	Electroconductive crevice nozzle made from sheet steel, DN 50, with 17 mm slot width.	<input type="checkbox"/>
Crevice nozzle 25 mm × 120 mm DN50	49	9.981-465.0	Electroconductive crevice nozzle made from sheet steel, DN 50, with 25 mm slot width.	<input type="checkbox"/>
Flexible crevice nozzles				
Flexible crevice nozzle silicone 65 mm DN50	50	9.988-403.0	Flexible crevice nozzle made from silicone, DN 50.	<input type="checkbox"/>
Flexible crevice nozzle 11 mm × 58 mm DN40	51	9.989-681.0	Electroconductive and flexible crevice nozzle, 11 × 58 mm.	<input type="checkbox"/>
Flexible crevice nozzle 20 mm × 45 mm DN40	52	9.981-423.0	Flexible and electroconductive crevice nozzle made from galvanised steel with 20 mm slot width, DN 40.	<input type="checkbox"/>
Flexible crevice nozzle 12 mm × 45 mm DN50	53	9.981-424.0	Flexible, electroconductive galvanised crevice nozzle, DN 50, with 13 mm slot width.	<input type="checkbox"/>
Flexible crevice nozzle 20 mm × 45 mm DN50	54	9.981-425.0	Flexible and electroconductive crevice nozzle made from galvanised steel with 20 mm slot width, DN 50.	<input type="checkbox"/>
Surface nozzles				
Silicone surface nozzle 120 mm DN40	55	9.988-118.0	Electroconductive rubber nozzle, angled, DN 40, suitable for use with foods.	<input type="checkbox"/>
Silicone surface nozzle 120 mm DN50	56	9.988-119.0	Electroconductive rubber nozzle, angled, DN 50, suitable for use with foods.	<input type="checkbox"/>

Available accessories.

ACCESSORIES FOR IVR-L 200/24-2 TC DP 9.989-404.0



	Order no.	Description	
NOZZLES			
Surface nozzles			
Aluminium surface nozzle, 150 mm, DN 40	57 9.989-666.0	Surface nozzle, 150 mm, made from aluminium. DN 40.	<input type="checkbox"/>
Aluminium surface nozzle 150 mm DN50	58 9.989-665.0	Surface nozzle, 150 mm, made from aluminium. DN 50.	<input type="checkbox"/>
Liquid nozzles			
Liquid nozzle 900 mm DN50	59 9.981-427.0	Bypass nozzle, DN 50, overall length: 1000 mm.	<input type="checkbox"/>
Borehole nozzles			
Blind hole nozzle DN40	60 9.989-671.0	90° curved blind hole nozzle with 60 mm diameter.	<input type="checkbox"/>
Blind hose nozzle angled 60° DN40	61 9.989-669.0	90° curved blind hole nozzle with 48 mm diameter. DN 40.	<input type="checkbox"/>
Blind hose nozzle angled 90° DN40	62 9.989-667.0	90° curved blind hole nozzle with 60 mm diameter. DN 40.	<input type="checkbox"/>
Blind hose nozzle angled 90° 200 mm extension DN40	63 9.989-670.0	90° curved blind hole nozzle with 48 mm diameter. DN 40.	<input type="checkbox"/>
BRUSHES			
Standard brushes			
Standard brush 40 mm DN40	64 9.981-431.0	Flat brush nozzle DN 40.	<input type="checkbox"/>
Standard brush 40 mm DN50	65 9.981-432.0	Flat brush nozzle DN 50.	<input type="checkbox"/>
End brushes			
End brush Ø 82 mm DN40	66 9.989-609.0	Electroconductive end brush with 82 mm diameter. DN 40.	<input type="checkbox"/>
End brush Ø 82 mm DN50	67 9.989-608.0	Electroconductive end brush with 82 mm diameter. DN 50.	<input type="checkbox"/>
Surface brushes			
Surface brush PP 24 mm DN40	68 9.989-610.0	Electroconductive surface brush. DN 40.	<input type="checkbox"/>
Surface brush 300 mm DN40	69 9.981-911.0	Vacuum brush, 300 mm, with 45° connection, with star screw, horsehair bristles.	<input type="checkbox"/>
Surface brush 300 mm DN50	70 9.981-912.0		<input type="checkbox"/>

Available accessories.

ACCESSORIES FOR IVR-L 200/24-2 TC DP

9.989-404.0

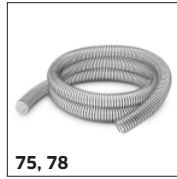

	Order no.	Description	
HOSES			
Hose installation sets			
Hose installation kit DN40	71 9.989-627.0	Multipiece hose connection set, DN 40.	<input type="checkbox"/>
Hose installation kit DN50	72 9.989-628.0	Multipiece hose connection kit, DN 50.	<input type="checkbox"/>
PU hoses			
Hose PU DN40 3 m	73 9.989-617.0	Oil-resistant, electroconductive PU hose, DN 40. Suitable for abrasive suction media and temperature-resistant up to 80 °C. Length: 3 m.	<input type="checkbox"/>
Hose PU DN40 5 m	74 9.989-618.0	Oil-resistant, electroconductive PU hose, DN 40. Suitable for abrasive suction media and temperature-resistant up to 80 °C. Length: 5 m.	<input type="checkbox"/>
PU hose DN40 15 m without connectors	75 9.989-637.0	PU hose without tap adapter, DN 40. Electroconductive and temperature-resistant up to 80 °C. Length: 15 m.	<input type="checkbox"/>
Hose PU DN50 3 m	76 9.989-619.0	Oil-resistant, electroconductive PU hose, DN 50. Suitable for abrasive suction media and temperature-resistant up to 80 °C. Length: 3 m.	<input type="checkbox"/>
Hose PU DN50 5 m	77 9.989-620.0	Oil-resistant, electroconductive PU hose, DN 50. Suitable for abrasive suction media and temperature-resistant up to 80 °C. Length: 5 m.	<input type="checkbox"/>
PU hose DN50 15 m without connectors	78 9.989-638.0	PU hose without tap adapter, DN 50. Electroconductive and temperature-resistant up to 80 °C. Length: 15 m.	<input type="checkbox"/>
ME-PU-hoses			
Hose ME-PU DN40 3 m	79 9.989-621.0	Electroconductive, oil-resistant ME-PU hose, DN 40. Suitable for abrasive suction media and temperature-resistant up to 110 °C. Length: 3 m.	<input type="checkbox"/>
ME-PU hose, DN 40, 5 m	80 9.989-622.0	Electroconductive, oil-resistant ME-PU hose, DN 40. Suitable for abrasive suction media and temperature-resistant up to 110 °C. Length: 5 m.	<input type="checkbox"/>
ME-PU hose DN40 15 m without connectors	81 9.989-640.0	Electroconductive, oil-resistant ME-PU hose without tap adapter, DN 40. Suitable for abrasive suction media and temperature-resistant up to 110 °C. Length: 15 m.	<input type="checkbox"/>
Hose ME-PU DN50 3 m	82 9.989-623.0	Electroconductive, oil-resistant ME-PU hose, DN 50. Suitable for abrasive suction media and temperature-resistant up to 110 °C. Length: 3 m.	<input type="checkbox"/>
Hose ME-PU DN50 5 m	83 9.989-625.0	Electroconductive, oil-resistant ME-PU hose, DN 50. Suitable for abrasive suction media and temperature-resistant up to 110 °C. Length: 5 m.	<input type="checkbox"/>
ME-PU hose DN50 15 m without connectors	84 9.989-641.0	Electroconductive, oil-resistant ME-PU hose without tap adapter, DN 50. Suitable for abrasive suction media and temperature-resistant up to 110 °C. Length: 15 m.	<input type="checkbox"/>

Available accessories.

ACCESSORIES FOR IVR-L 200/24-2 TC DP 9.989-404.0



	Order no.	Description	
ADAPTERS / REDUCERS / DISTRIBUTORS			
Accessories adapter			
Adapter accessories DN 50 to DN 51	85 9.989-603.0	Steel adapter for connection of DN 50 to DN 51. Electroconductive.	<input type="checkbox"/>
Adapter accessories DN 51 to DN 50	86 9.989-601.0	Steel adapter for connection of DN 51 to DN 50. Electroconductive.	<input type="checkbox"/>
Adapter accessories DN50 to DN61	87 9.989-602.0	Steel adapter for connection of DN 50 to DN 61. Electroconductive.	<input type="checkbox"/>
Adapter accessories DN 61 to DN 50	88 9.989-604.0	Steel adapter for connection of DN 61 to DN 50. Electroconductive.	<input type="checkbox"/>
Reducers/expanders			
Reduction DN50 to DN40	89 9.981-231.0	Reducer from DN 50 to DN 40. Material: Steel. Electroconductive.	<input type="checkbox"/>
Expander			
Expansion DN50 to DN70	90 9.981-921.0	Reducer from external cone DN 50 to internal cone DN 70. Material: Steel. Electroconductive.	<input type="checkbox"/>
Distributor			
Y-piece fitting DN50 to DN40	91 9.981-149.0	Manifold, electroconductive, steel, DN 50/40/40.	<input type="checkbox"/>
FILTERS			
Surface filter			
Surface filter PE L 0.45 m ²	92 9.988-256.0		<input type="checkbox"/>
EMPTYING SUPPORTS			
Strainer baskets			
Filter basket, stainless steel, Ø 495 mm, 40 l	93 9.980-849.0	Filter basket, stainless steel, 40 l, hole diameter 1.5 mm. For the efficient separation of liquids and shavings.	<input type="checkbox"/>
Other emptying aids			
Overfill protection dia. 540 mm	94 9.982-117.0	Float insert, stainless steel, for overfill prevention with ball float, central suction.	<input type="checkbox"/>
PRE-SEPARATORS			
Pre-separator			
Pre-separator Tc Op liquids 125 l DN70	95 9.989-686.0	125 litre pre-separator, DN 70.	<input type="checkbox"/>
Pre-separator drum 200 l	96 9.989-685.0	Standard drum which complies with the ISO 15750-2 standard.	<input type="checkbox"/>
Pre-separator lid			
Pre-separator cover Op liquids ø 517 mm DN70	97 9.981-666.0	Pre-separator cover DN 70. Suitable for containers with 517 mm diameter.	<input type="checkbox"/>
Pre-separator cover Op liquids ø 575 mm DN70	98 9.981-662.0	Pre-separator cover DN 70 for 200 litre standard drum (9.989-685.0).	<input type="checkbox"/>

Available accessories.

**ACCESSORIES FOR IVR-L 200/24-2 TC DP
9.989-404.0****97-100**

		Order no.	Description	
PRE-SEPARATORS				
Pre-separator lid				
Pre-separator cover solid materials ø 517 mm DN70	99	9.981-665.0	Pre-separator cover DN 70. Suitable for containers with 517 mm diameter.	<input type="checkbox"/>
Pre-separator cover solid materials ø 575 mm DN70	100	9.981-661.0	Pre-separator cover DN 70 for 200 litre standard drum (9.989-685.0).	<input type="checkbox"/>

Available accessories.