

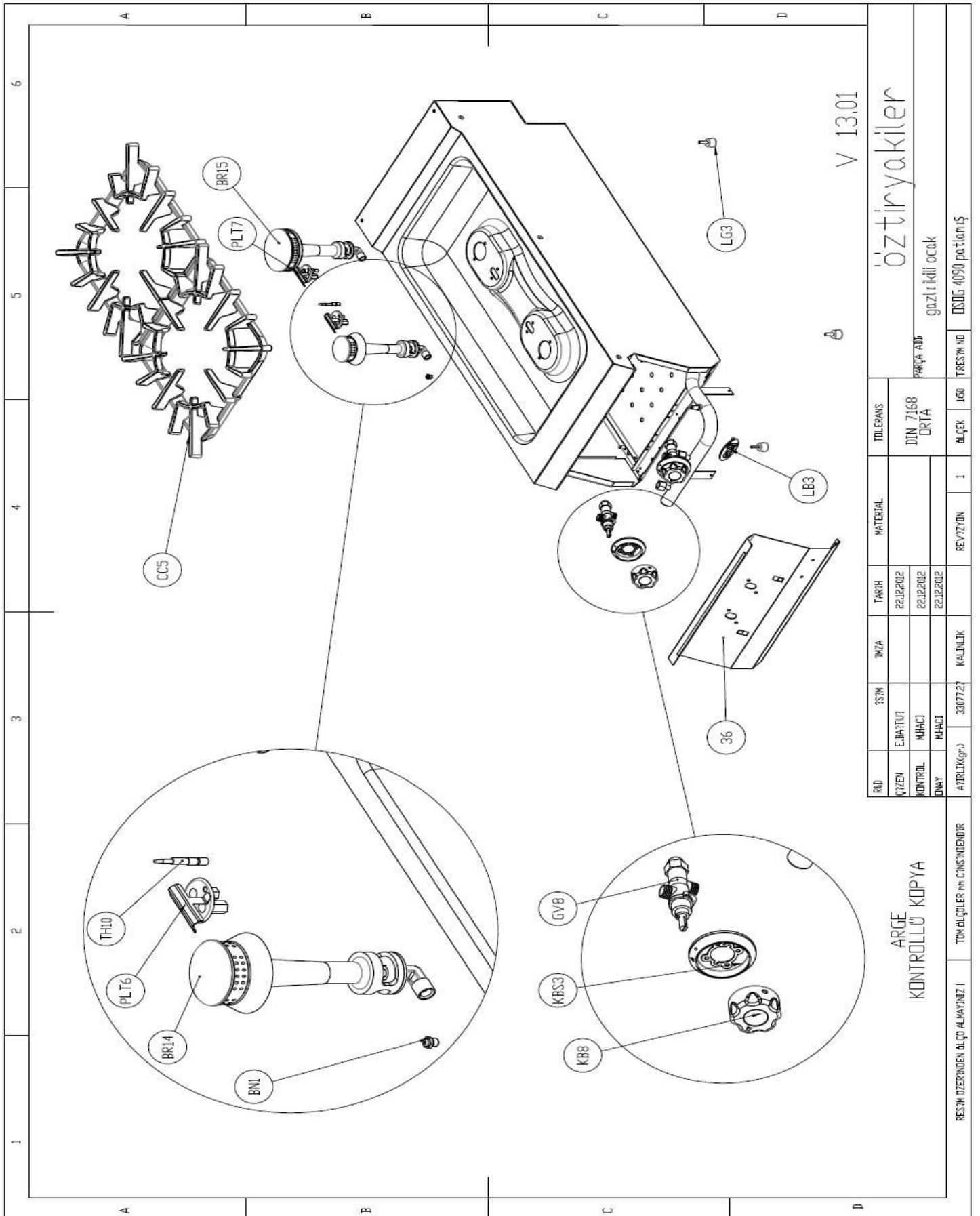

## SPARE PART LIST

Spare Part ItemCode	Item name.	PictureId	Price.	Curr.
2865.N20.04000290.G.10	FRONT PANEL FOR 40'S GAS COOKER	36		
2KLP.460.626700006.05	MAIN BURNER NOZZLE M8x0,75 ANY GAS TYPE	BN1		
6267.00002.048	BURNER ASSEMBLY 6 Kw FOR 900 SERIES GAS COOKERS	BR14		
6267.00002.046	BURNER ASSEMBLY 10 Kw FOR 900 SERIES GAS COOKERS	BR15		
6260.00058.43	PAN SUPPORT CAST IRON W CERAMIC ENAMEL COATED FOR 900 SERIES COOKERS	CC5		
6260.00058.96	FLUE COVER CAST IRON WITH CERAMIC ENAMEL COATED FOR ALL 700&900	FCT1		
9099.00A60.00	GAS VALVE MAX-MIN ADJUSTMENT PILOT OUTPUT WITH THERMOCOUPLE SAFE 21S	GV8		
6260.00015.601	METAL DUGME PLASTIK GOBEGI 8 LİK	KB8		
6260.00015.63C	DUGME METAL INSERTSUZ-KROM KAPLI	KB8		
6260.ALEVC.55CS	KNOB METAL CHROME COATED	KBS3		
2179.09028.01B	LABEL SMALL ÖZT RYAK LER-PAINTED	LB3		
2179.09028.01	LABEL FOR FRONT PANEL "ÖZT RYAK LER"	LB3		
6260.00002.05	ADJUSTABLE LEG M6	LG3		
6267.00020.33	PILOT BURNER ASSEMBLY LONG FOR 900 SERIES COOKERS	PLT6		
6267.00020.51	PILOT ASSEMBLY SHORT	PLT7		
6267.00024.00	THERMOCOUPLE 9/1 600 mm LENGTH	TH10		



öztiyākiler

PARÇA ADI  
gazlı ikili ocak

OSOG 4090 patlamış

NO	TSİM	TAHZA	TARİHİ	MATERIAL	TOLERANS
ÇİZEN	E.İBATTUT		22.12.2012		DIN 7168
KONTROL	M.HACI		22.12.2012		ORTA
ONAY	M.HACI		22.12.2012		
AZTOLUK(GP.)	33077.27	KALINLIK		REVİZYON	1
ALÇEK	160				

ARGE  
KONTROLLÜ KOPYA

TİM ALÇUKLER İM CİNSİNDİR