



7865.N1.80708.10ELP

700 SER KUZ NE FIRINLI GAZLI 4 AÇIK ATE 80\*70\*85 (LP)-2x6kW+2x7,5kW+6kW  
ELEKTR KL FIRIN

Version No: V17.06

## SPARE PART LIST

Spare Part ItemCode	Item name.	PictureId	Price.	Curr.
2KLP.460.626700006.05	MAIN BURNER NOZZLE M8x0,75 ANY GAS TYPE	BN1		
6267.00001.28	BURNER 6,5KW 700 SERI	BR26		
6267.00001.29	BURNER HORIZONTAL 8,5-9 KW NICKEL COATED 700 SERI	BR27		
6260.00058.49	COOKER CAST 650/700/750 SERI 55*35(3,9KG/QT)	CC3		
6019.00005.28	OVEN WIRE SHELF FOR 80'S STATIC OVENS 650x535mm CHROME COATED	CC6		
2171.00KT2.03	SCRAB HOLDER S/S FOR NEW 700 SERIES GAS COOKERS WITH PILOT OPENING	CP1		
6230.00014.31	CONTACTOR 220V 4KW	CR7		
6260.00058.96	FLUE COVER CAST IRON WITH CERAMIC ENAMEL COATED FOR ALL 700&900	FCT1		
9099.00A60.00	GAS VALVE MAX-MIN ADJUSTMENT PILOT OUTPUT WITH THERMOCOUPLE SAFE 21S	GV8		
6260.00010.34	OVEN DOOR HANDLE 538mm L 15x32mm CHROM COATED	HND7		
6201.00007.05	HINGE FOR STATIC GAS OVEN DOOR-RIGHT 700-900	HNG2		
6201.00007.06	HINGE FOR STATIC GAS OVEN DOOR-LEFT	HNG3		
6201.00007.07	HINGE BALANCER FOR STATIC GAS OVEN DOOR 700-900	HNG4		
6246.00025.18	HEATING ELEMENT 3700 W 230 V FOR 80'S STATIC OVEN	HR20		
6246.00025.17	HEATING ELEMENT 2300 W 230 V FOR 80'S STATIC OVEN	HR21		
6260.00015.45	THERMOPLASTIC KNOB MAIN BODY WITH 6 mm INSERT	KB6		
6260.00015.46	THERMOPLASTIC KNOB MAIN BODY WITH 8 mm INSERT	KB8		
6260.00015.40	THERMOPLASTIC KNOB SCALE MAX.-MIN FLAME-LIGHTING	KBS3		
6260.00015.49	THERMOPLASTIC KNOB SCALE WITH "O" MARKED FOR "OK"	KBS4		
6260.00015.32	THERMOPLASTIC KNOB SCALE 50-300 C	KBS9		
2179.09028.01	LABEL FOR FRONT PANEL "ÖZT RYAK LER"	LB3		
6260.00002.10	STAINLESS STEEL LEG 130-150 MM	LG10		
6260.00111.21	OVEN RAIL WIRE 900 SERI	OR1		
6259.00003.10	CABLE GLAND PG 21	PG21		
6259.00003.13	CABLE GLAND PG 29	PG29		
6267.00023.08	PILOT ASSEMBLY 2 WAY FOR 700 SERIES GAS COOKER&WOK&BROILERS	PLT5		
6254.00005.04	4 POLE ON-OFF SWITCH	SW3		
6232.00027.09	4 POS. SELECTOR SWITCH RTH C01	SW7		
6267.00024.00	THERMOCOUPLE 9/1 600 mm LENGTH	TH10		
6234.00001.05	THERMOSTAT 50-300 C MONOPHASE	TH14		

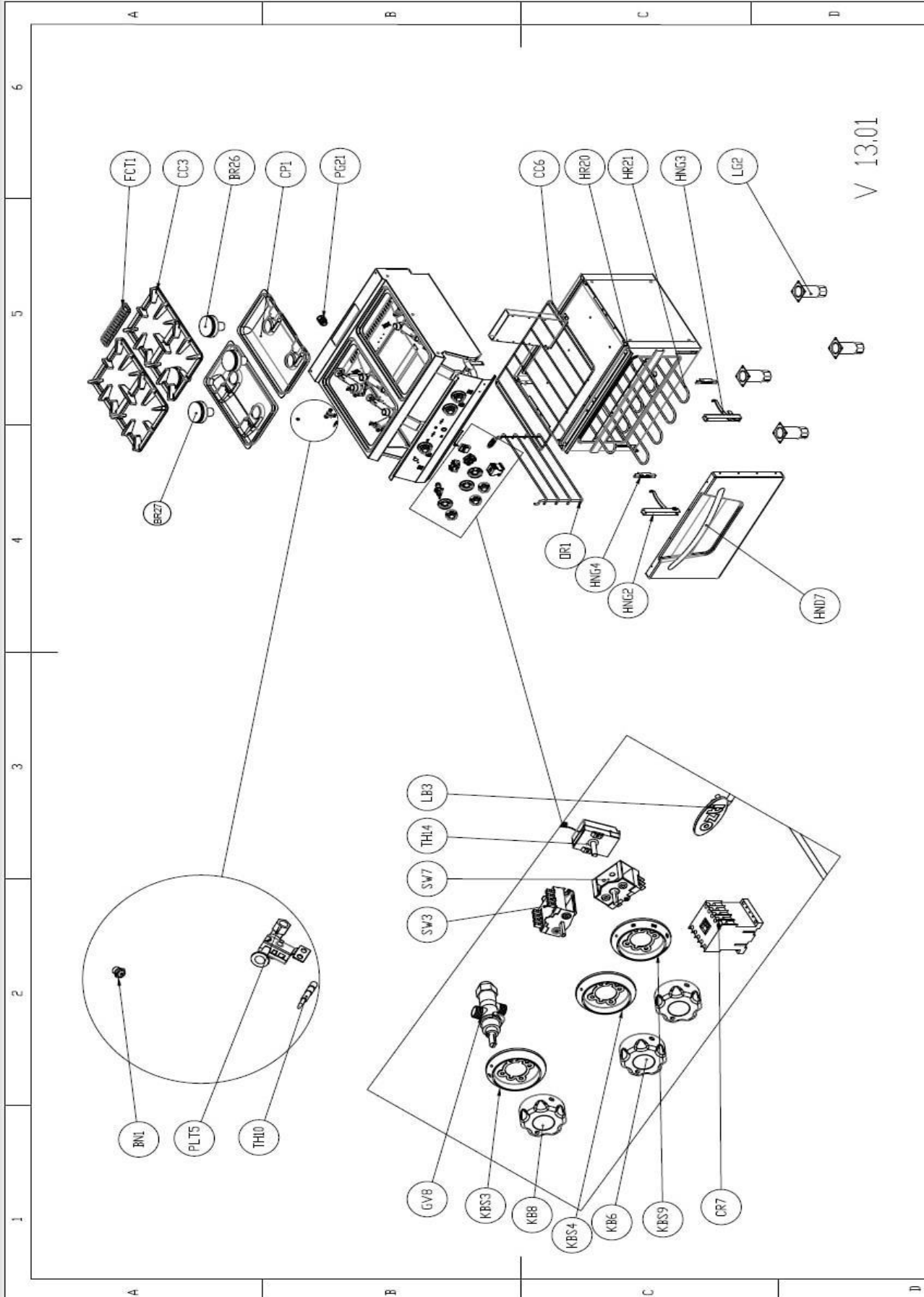

RİD		İSİM	İMZA	TARİH	MATERIAL	TOLERANS
ÇİZEN	EDİTÖR			22.12.2012		DIN 7168
KONTROL	M.HACI			22.12.2012		DRTA
İMZA	M.HACI	10425979	KALINLIK			
RESİM ÜZERİNDEKİ ALÇI ALMAYINIZ!		TAM BİÇİMLER İN ÇİNSİNİNDİR				
ARGE		KONTROLLÜ KOPYA				
PARÇA ADI		4 gazlı ocaklı elektrikli kuzine				
TARİHİ NO		DSJEEF 8070 ELP partıamış				
ALÇEK		1				