

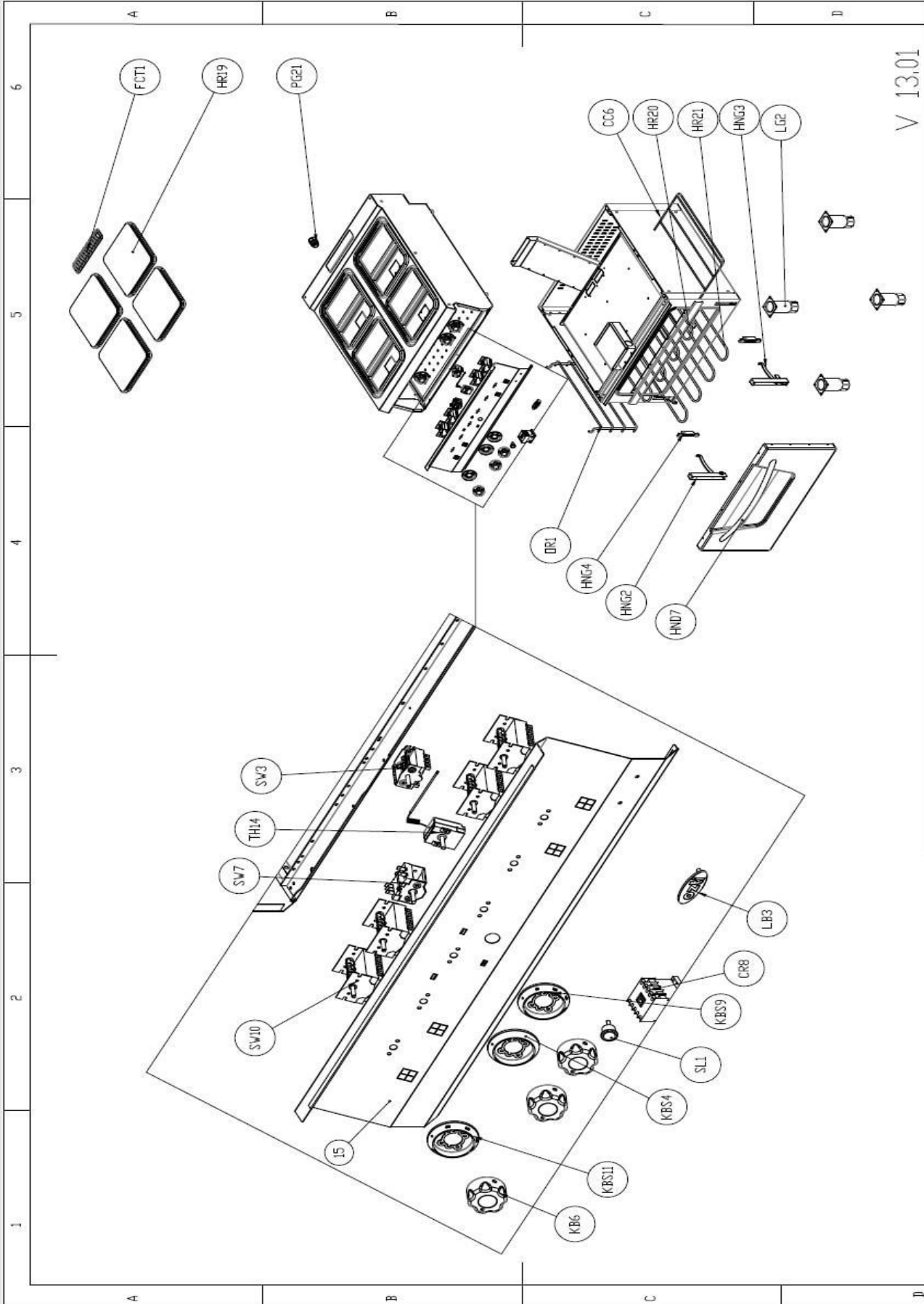

## SPARE PART LIST

| Spare Part ItemCode    | Item name.  | PictureId | Price. | Curr. |
|------------------------|---|-----------|--------|-------|
| 2865.N20.08000290.K.10 | FRONT PANEL FOR 80'S ELECTRICAL RANGE                           | 15        |        |       |
| 6019.00005.28          | OVEN WIRE SHELF FOR 80'S STATIC OVENS 650x535mm CHROME COATED   | CC6       |        |       |
| 6230.00017.01          | Contacto GMC-9M 1024VAC 220V L                                  | CR8       |        |       |
| 6260.00058.96          | FLUE COVER CAST IRON WITH CERAMIC ENAMEL COATED FOR ALL 700&900 | FCT1      |        |       |
| 6260.00010.34          | OVEN DOOR HANDLE 538mm L 15x32mm CHROM COATED                   | HND7      |        |       |
| 6201.00007.05          | HINGE FOR STATIC GAS OVEN DOOR-RIGHT 700-900                    | HNG2      |        |       |
| 6201.00007.06          | HINGE FOR STATIC GAS OVEN DOOR-LEFT                             | HNG3      |        |       |
| 6201.00007.07          | HINGE BALANCER FOR STATIC GAS OVEN DOOR 700-900                 | HNG4      |        |       |
| 6246.00014.00          | HOT PLATE 4 Kw 230 V 30x30 SQUARE                               | HR19      |        |       |
| 6246.00025.18          | HEATING ELEMENT 3700 W 230 V FOR 80'S STATIC OVEN               | HR20      |        |       |
| 6246.00025.17          | HEATING ELEMENT 2300 W 230 V FOR 80'S STATIC OVEN               | HR21      |        |       |
| 6260.090450.55CS       | DUGME VOLANI METAL KROM KAPLI 90-450 SERIGRAFI BASKILI          | KBS11     |        |       |
| 6260.00015.600         | METAL BUTTON PLASTIC HUB  | KBS4      |        |       |
| 6260.00015.63C         | DUGME METAL INSERTSUZ-KROM KAPLI                                | KBS4      |        |       |
| 6260.OKBASKI.55CS      | KNOB METAL CHROME COATED  | KBS4      |        |       |
| 6260.050300.55CS       | DUGME VOLANI METAL KROM KAPLI 50-300 SERIGRAFI BASKILI          | KBS9      |        |       |
| 2179.09028.01          | LABEL FOR FRONT PANEL "ÖZT RYAK LER"                            | LB3       |        |       |
| 6260.00002.10          | STAINLESS STEEL LEG 130-150 MM                                  | LG10      |        |       |
| 6260.00111.21          | OVEN RAIL WIRE 900 SERI   | OR1       |        |       |
| 6259.00003.10          | CABLE GLAND PG 21   | PG21      |        |       |
| 6254.00005.00          | 5 POLE SWITCH FOR HOT PLATES                                    | SW10      |        |       |
| 6254.00005.04          | 4 POLE ON-OFF SWITCH  | SW3       |        |       |
| 6232.00027.09          | 4 POS. SELECTOR SWITCH RTH C01                                  | SW7       |        |       |
| 6234.00001.05          | THERMOSTAT 50-300 C MONOPHASE                                   | TH14      |        |       |
| 6248.00010.01          | ELECTRICAL TERMINAL (GROUNDING)                                 | TRL1      |        |       |
| 6248.00011.11          | ELECTRICAL TERMINAL AVK 16 BEIGE                                | TRL2      |        |       |
| 6248.00011.15          | ELECTRICAL TERMINAL AVK 10 BLUE                                 | TRL3      |        |       |
| 6248.00011.00          | ELECTRICAL TERMINAL KD-3 495040 BEIGE                           | TRL7      |        |       |
| 6248.00022.00          | RAIL FOR TERMINAL ST  | TRN1      |        |       |



V 13.01

öztiyakerler

PARÇA ADI  
4 ocaklı elektrikli kuzine

TOLERANS  
DIN 7168  
ORTA

MATERIAL

REVİZYON 1

TARİH  
22.12.2012

İNHA

KALINLIK

98305.94

ADLİK(gp.)

M.HACI

M.HACI

98305.94

TOM ALIÇLER İN ÇİNSİNDİR

ARGE  
KONTROLLÜ KOPYA

REVİZYON ALIÇI ALIYANIZI

ALIÇEK 1000

TRFESİM NO DSDEF 8090 partians