

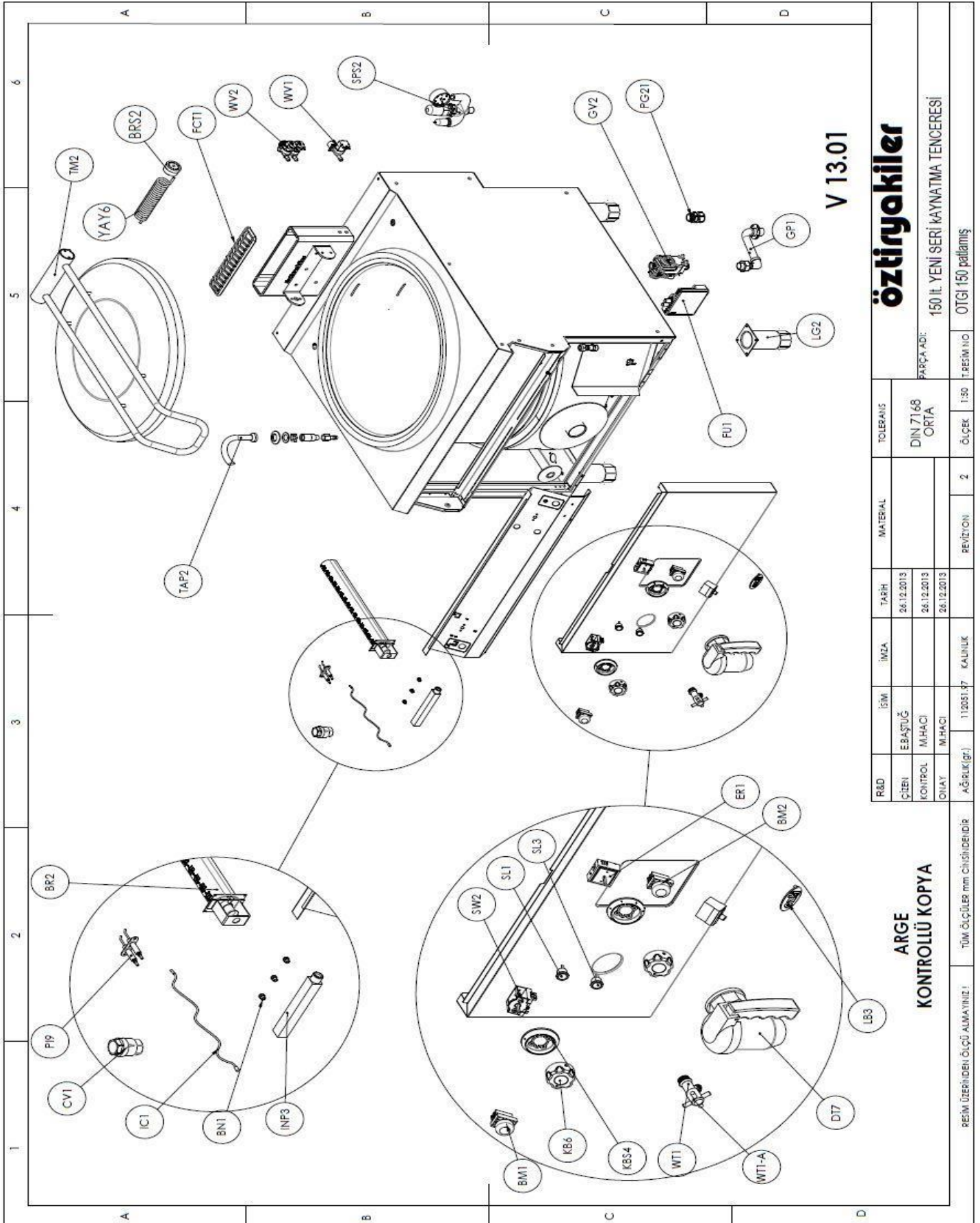

## SPARE PART LIST

Spare Part ItemCode	Item name.	PictureId	Price.	Curr.
6232.00012.08	Moeller Button Top DR-G	BM1		
6232.00012.13	ROUND BUTTON WITH NO CONTACT Ø22mm RED SPRING BACK	BM2		
6267.M8075.075	ENJEKTOR M8*0,75 -Q 0,75 MM	BN1		
6267.00002.62	BURNER TUBE S/S 400 mm LENGTH	BR2		
2KLP.460.626000100.08	SPRING BALANCER-12-BRASS FOR LID LIFTING MECHANISM OF BOILING PANS	BRS2		
6222.00027.12	RATCHET VALVE 1/2 BRASS AGA	CV1		
6222.00006.43	DRAIN TAP 2" LIVA	DT7		
6234.00001.110	ENERJİ REGULATORU METAL SAFTLI 240 V (50.87071.012/01)	ER1		
6260.00058.96	FLUE COVER CAST IRON WITH CERAMIC ENAMEL COATED FOR ALL 700&900	FCT1		
6267.00019.03	FLEXIBLE GAS PIPE FOR INDIRECT BOILING PANS R1/2" x 300 mm L	FP1		
6259.00020.061	ELECTRONIC IGNITION MODULE S4565 A 2019 -1	FU1		
6267.00002.194	GAS TRAIN FOR GAS BOILING PANS	GP1		
6267.00005.30	GAS VALVE FOR ELECTRONIC IGNITION SYSTEMS VK4105C	GV2		
6267.00031.19	IGNITER CABLE SF4DO+4,8*0,8 L 100	IC1		
2KLP.460.626000002.29	NOZZLE GAS TRAIN SQUARE STEEL FOR 3 BURNERS OF BOILING PANS	INP3		
6260.OKBASKI.55CS	KNOB METAL CHROME COATED	KBS4		
6260.00015.600	METAL BUTTON PLASTIC HUB	KBS4		
6260.00015.63C	DUGME METAL INSERTSUZ-KROM KAPLI	KBS4		
2179.09028.01B	LABEL SMALL ÖZT RYAK LER-PAINTED	LB3		
2179.09028.01	LABEL FOR FRONT PANEL "ÖZT RYAK LER"	LB3		
6260.00002.10	STAINLESS STEEL LEG 130-150 MM	LG10		
6259.00003.10	CABLE GLAND PG 21	PG21		
6267.00031.23	DOUBLE PLUG FOR BOILING PAN	PI9		
6251.00004.30	SIGNAL LAMP BLACK BODY GREEN LENS NEON 100K-220V	SL1		
6251.00004.31	SIGNAL LAMP BLACK BODY RED LENS NEON 100K-220V	SL3		
6260.00151.17	BUHAR BASINÇ GÜVENL K VALF KOMPLE (ÇATAL/VALF/MANOMETRE)	SPS2		
6232.00027.02	4 POS. SELECTOR SWITCH RTH D01	SW2		
6222.00015.25	FILLING SPOUT FOR BOILING PAN	TAP2		
2855.N30.GR002.MK	60-100-150 LT LID MECHANISM GROUP	TM2		
6222.00009.04	WATER TAP FOR LEVELING	WT1		
6222.00009.05	KNOB FOR WATER LEVELLING TAP OF INDIRECT BOILING PANS	WT1-A		
6262.00008.00	3/4 PLASTIC VALVE	WV1		
6258.00003.00	SELENOID VALVE R3/4" SINGLE IN DOUBLE OUT 220V WITH PLASTIC FLANGE	WV2		
6205.00022.01	SPRING Ø34x180x5 mm FOR LID LIFTING MECHANISM OF BOILING PANS	YAY6		



# öztiyakiler

PARÇA ADI: 150 LT. YENİ SERİ KAYNATMA TENCERESİ

R&D	İSİM	İMZA	TARİH	MATERYAL	TOLERANS
ÇİZEN	ERBAŞTUĞ		26.12.2013		DIN 7168
KONTROL	MİHACI		26.12.2013		ORTA
ONAY	MİHACI		26.12.2013		
AĞIRLIK(gr.)	110051.97	KALINLIK		REVİZYON	2
				ÖLÇEK	1:50

ARGE  
KONTROLLÜ KOPYA

RESİM ÜZERİNDEN ÖLÇÜ ALMAYINIZ! TÜM ÖLÇÜLER mm ÇİKSİNDİRİDİR