



## SPARE PART LIST

Spare Part ItemCode	Item name.	PictureId	Price.	Curr.
9099.L80T7.5SX	BYM OLYMPIA 500 / GIYOTIN YIKAMA POMPASI (L80.T75SX)			
6262.00041.03	NAVEL AXLES			
6262.00028.07	Hood H type drain plug			
6262.00021.38	Hood type washing distribution hose			
6262.00024.04	Water inlet bottom nut			
6221.00001.040	CLAMP 40-60MM			
6226.00004.030	Washing Pipe Top Part Seal			
6262.00027.05	Suction filter lower part			
6262.00024.03	OBY 35 / 40 / 1080 / OKY PLASTIK YIKAMA GOBEK			
6221.00001.050	Clamp 50x70			
6262.00027.07	Suction filter top part			
2710.F0001.01	DOOR TYPE MAGNET WITH COVER			
6226.00004.040	GASKET-BLACK(EXT DIM Ø69/ DIM IN Ø55/K.4_5MM EPDM)			
6262.00021.071	Washing pump connecting Hose			
6262.00041.04	Special Screw M8			
2710.F1000.03	1080 BOILER TANK (OZTI HOOD TYPE)			
6221.00001.030	CLAMP 32*50 MM			
6262.00003.06	Slide pulley bolt			
6262.00021.13	Water discharge hose Ø30x250 cm double sided			
9099.FPD18.0A	PLS VENTIL 3/4 TEKLI FPD180A G3/4_D12 / 220-240V 50/60 Hz (YINHAO/CEKVALFLI)			
6221.00001.020	Clamp 12x20			
6228.00001.35	Q RING			
6228.00001.110	Q RING			
6262.00026.03	Air trap (Plastic)			
6226.00021.13	Grommet for Drain Hose			
6222.00027.01	CEKVALF PLASTIK DN20 (20MM 3/4" PLASTIK VENTIL ICIN)			
6262.00020.31	KULLANMA KLAVUZU (1080 DIJITAL) TURKCE			
6262.00071.37	KOMITATOR DUGMESI Q6 mm (YARIM KAZAN 1080 KNOB) SERIGRAFI BASKISI DAHIL GRI			
2710.1080H.05	Stainless Steel Strainer			
6262.00033.06	Washing Pipe Top Part Nut			
6262.00033.33	Washing&Rinsing Arm (Completely) plst.			
6262.00027.06	Suction filter center part			
6226.00004.07	Suction filter seal			
9099.01000.13	Hood Type Washing Tank heater 2000W 230V			
6606.00001.12	Grommet rubber Ø8x16			
6262.00025.03	BYM 1080 UST YIKAMA/DURULAMA DIRSEK PLS. (YENI)			
6262.00021.78	HORTUM BASKILI DURULAMA Y PARCA HOOD TYPE OBM 1080 (Rekorlu 570x630x570 mm) UZUN SASE			
2710.50109.B02	BYM 1080 HOOD TYPE THERMOSTAT BAGLANTI SACI			
6262.00021.18	HOSE 1/2" WITH WRAPPED Resistant to 125o heat/15 bar			
6228.00001.36	ORING Q35*2,5 mm			
6262.00003.20	KIZAK MAKARASI 1080 T/S			
6262.00030.05	Ring of Water Canalize			
6251.00004.48	SIGNAL LAMB-ANEL S49			
9099.00001.85	TERMOSTAT LIMIT RESETSIZ 75 C (MERCIMEK TIP) T1/11-75/55C			
6226.00006.02	Gasket for air trap			
6262.00022.13	Hood handle side guide			
6231.00019.46	ROLE ZAMAN EMKO-BYM-01 (MAVI RENK - 50 / GIYOTIN)			
6232.00005.10	Magnetic switch			
6262.30666.013	Rinse-aid connection check valve			
6262.00033.04	Washing Pipe Top Part			
6262.00007.00	Water Level Switch			
6234.00001.037	TERMOSTAT AYNA+KAPAK 30-120 C (EGO)			
2710.11001.10	BYM 1080 HOOD TYPE ALT SASE MEKANIK ON PANEL YARIM KAZAN			
9099.00011.41	BUTON BLUE KALICILI MAVI POWER LOGOLU (LEDLI DUGME ONPOW / DAILYWELL KPB22-88P1-F11-			
2710.57885.01	BYM 1080 HOOD TYPE OZTIRYAKILER SEPET OTURAGI KOMPLE			
2710.10002.21	Rear external cover			
9099.00011.42	BLUE BUTTON KPB22			
9099.R63T3.30	RINCING PUMP	68		
6262.00021.18	HOSE 1/2" WITH WRAPPED Resistant to 125o heat/15 bar	69		
9099.01000.06	HEATING ELEMENT 9000 W IRCA INCOLOY 800 ( 1080-1500-2000 BOILER )	72		
6221.00001.020	Clamp 12x20	77		
6232.00027.00	Programme Switch	82		
9234.00001.68	THERMOSTAT 170 C LIMIT ( FSTB WYF170G-ZS4)	84		
6234.00001.019	THERMOSTAT 30-120°C FSTB WYF120S-061	85		
2710.10003.09	BYM 1080 HOOD TYPE ELEKTRIK PANOSU RAKORSUZ SURGULU	94		



Cumhuriyet Mah.Hadımköy Yolu Caddesi No:8 1Nolu Bağımsız Bölüm  
Büyüçkekmece İstanbul VD: BüyükMükellefler VKN: 7080013433

Phone.: 00 90 212 8867800

Fax No: 00 90 212 8867809

Page 2

071M.00100.BB

HOOD TYPE DISHWASHER (MECHANICAL & HALF TANK) OBM 1080M R

Version No: V22.04

6260.00002.10

PIPE FEET 130-180MM TOP TABLE 90\*100

LG10

9099.00004.17

MIKNATIS D18\*D6\*10MM N35\_NICUNI NEODYMIUM

MGT4

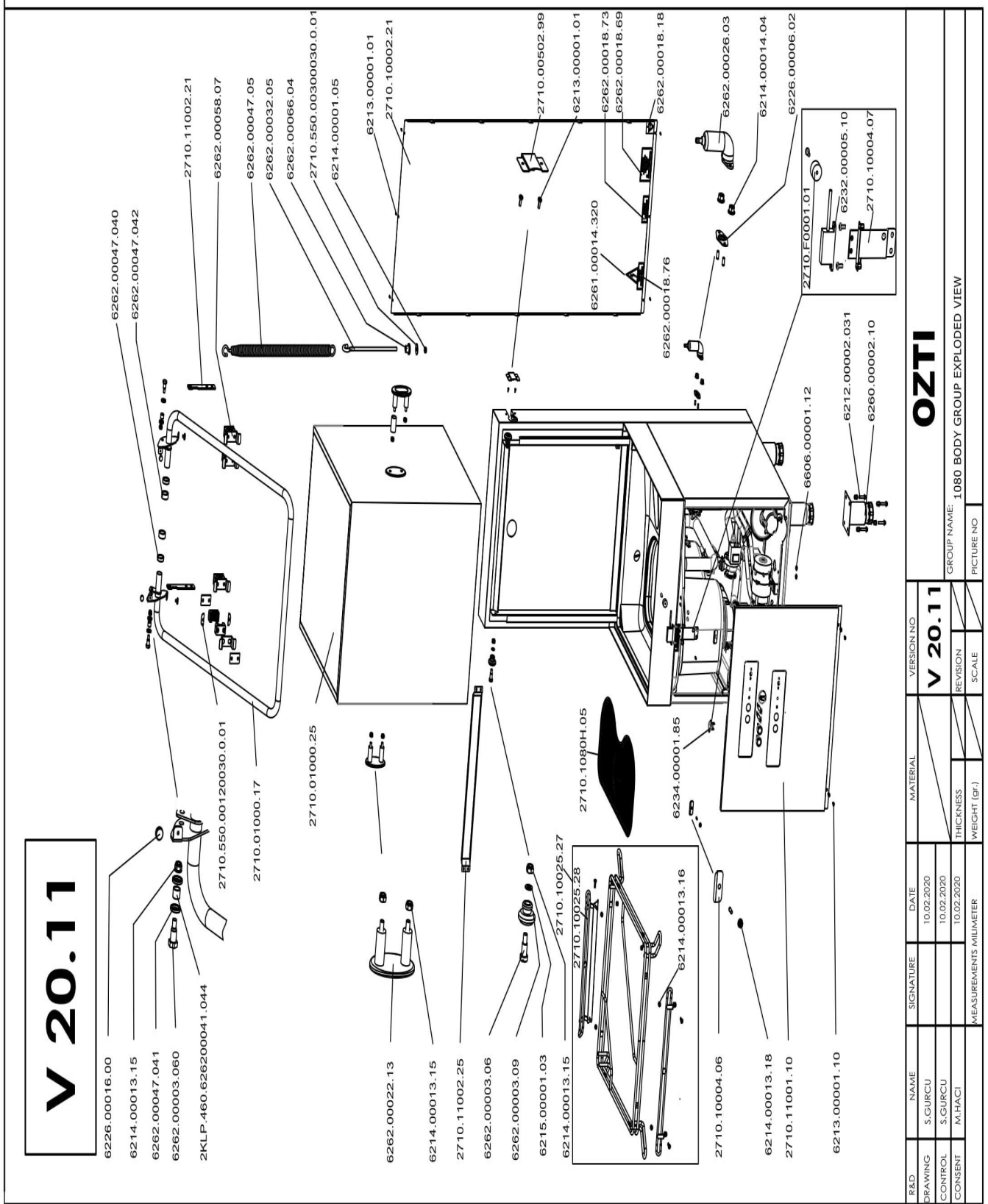

**OZTI**

GROUP NAME: 1080 BODY GROUP EXPLODED VIEW

PICTURE NO

R&D	NAME	SIGNATURE	DATE	MATERIAL	VERSION NO
DRAWING	S.GURCU		10.02.2020		V 20.11
CONTROL	S.GURCU		10.02.2020	THICKNESS	REVISION
CONSENT	M.HACI		10.02.2020	WEIGHT (GR.)	SCALE

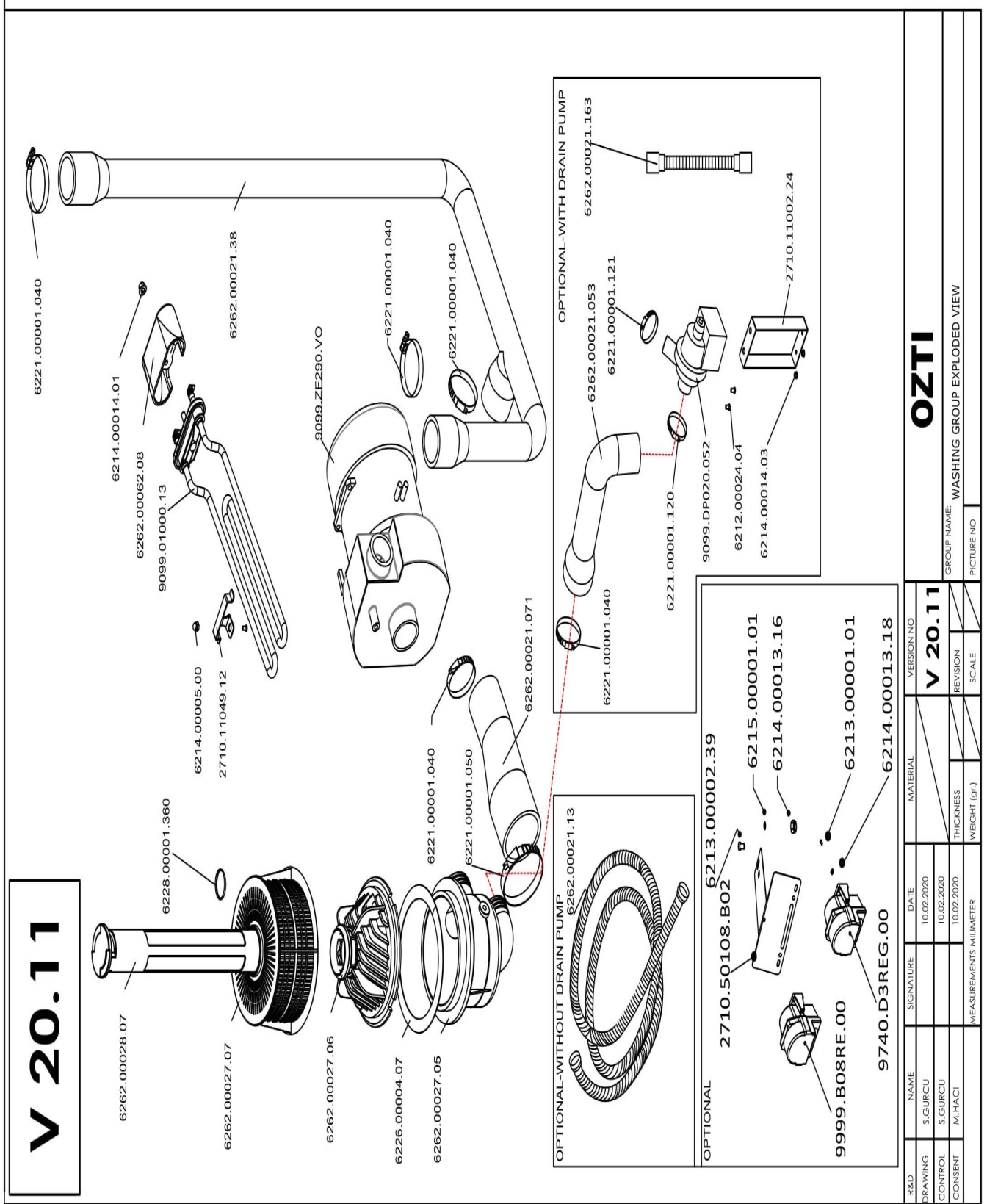



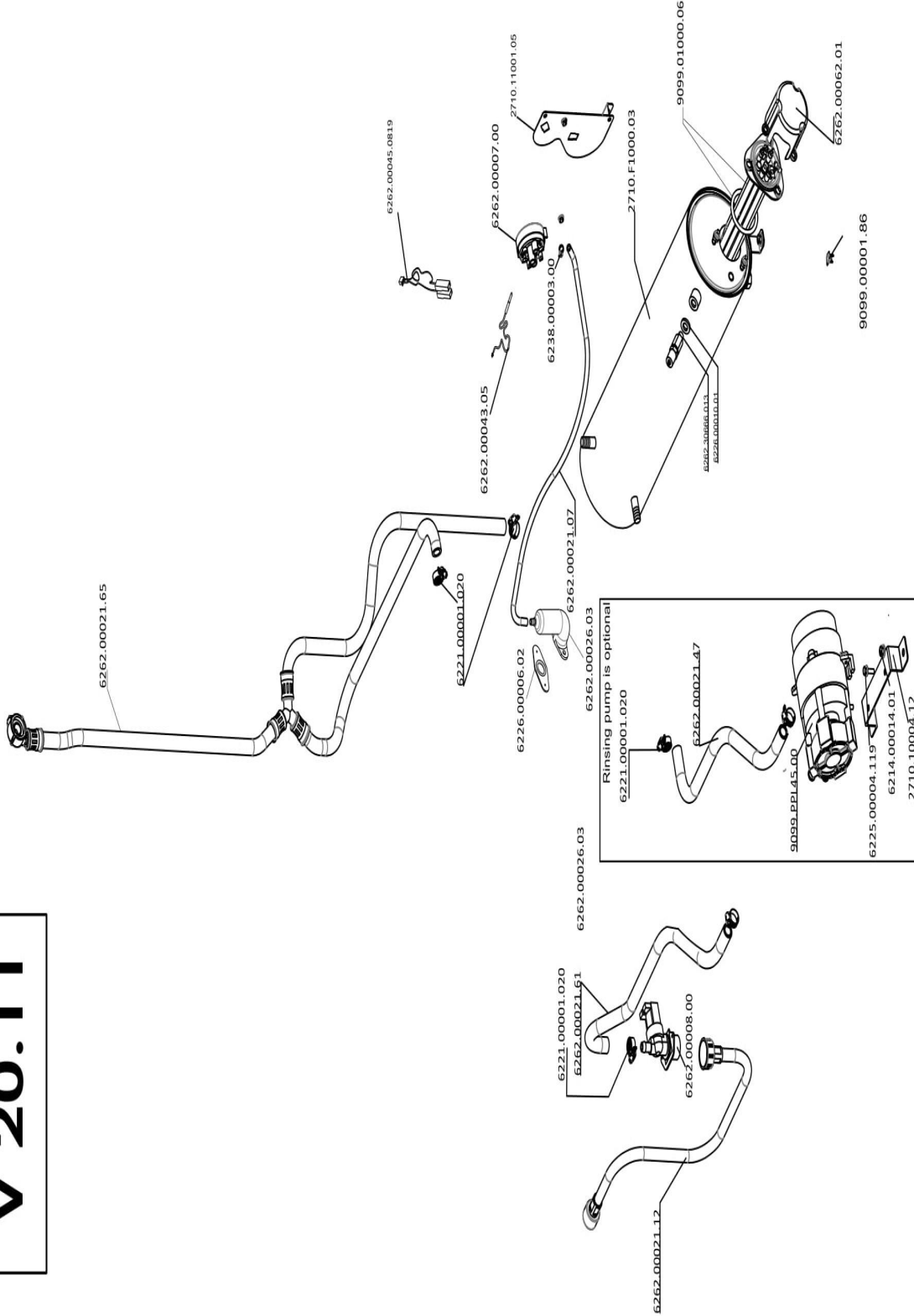

V 20.11

OZTI

VERSION NO  
V 20.11

MATERIAL

DATE

SIGNATURE

NAME

R&amp;D

10.02.2020

S.GURCU

S.GURCU

DRAWING

10.02.2020

S.GURCU

M.HACI

CONTROL

10.02.2020

M.HACI

M.HACI

CONSENT

10.02.2020

M.HACI

M.HACI

CONTROL

10.02.2020

M.HACI

M.HACI

CONSENT

10.02.2020

M.HACI

M.HACI

CONSENT

10.02.2020

M.HACI

M.HACI

CONSENT

10.02.2020

M.HACI

M.HACI

CONSENT

10.02.2020

M.HACI

M.HACI

CONSENT

10.02.2020

M.HACI

M.HACI

CONSENT

10.02.2020

M.HACI

M.HACI

CONSENT

10.02.2020

M.HACI

M.HACI

CONSENT

10.02.2020

M.HACI

M.HACI

CONSENT

10.02.2020

M.HACI

M.HACI

CONSENT

10.02.2020

M.HACI

M.HACI

CONSENT

10.02.2020

M.HACI

M.HACI

CONSENT

10.02.2020

M.HACI

M.HACI

CONSENT

10.02.2020

M.HACI

M.HACI

CONSENT

10.02.2020

M.HACI

M.HACI

CONSENT

10.02.2020

M.HACI

M.HACI

CONSENT

10.02.2020

M.HACI

M.HACI

CONSENT

10.02.2020

M.HACI

M.HACI

CONSENT

10.02.2020

M.HACI

M.HACI

CONSENT

10.02.2020

M.HACI

M.HACI

CONSENT

10.02.2020

M.HACI

M.HACI

CONSENT

10.02.2020

M.HACI

M.HACI

CONSENT

10.02.2020

M.HACI

M.HACI

CONSENT

10.02.2020

M.HACI

M.HACI

CONSENT

10.02.2020

M.HACI

M.HACI

CONSENT

10.02.2020

M.HACI

M.HACI

CONSENT

10.02.2020

M.HACI

M.HACI

CONSENT

10.02.2020

M.HACI

M.HACI

CONSENT

10.02.2020

M.HACI

M.HACI

CONSENT

10.02.2020

M.HACI

M.HACI

CONSENT

10.02.2020

M.HACI

M.HACI

CONSENT

10.02.2020

M.HACI

M.HACI

CONSENT

10.02.2020

M.HACI

M.HACI

CONSENT

10.02.2020

M.HACI

M.HACI

CONSENT

10.02.2020

M.HACI

M.HACI

CONSENT

10.02.2020

M.HACI

M.HACI

CONSENT

10.02.2020

M.HACI

M.HACI

CONSENT

10.02.2020

M.HACI

M.HACI

CONSENT

10.02.2020

M.HACI

M.HACI

CONSENT

10.02.2020

M.HACI

M.HACI

CONSENT

10.02.2020

M.HACI

M.HACI

CONSENT

10.02.2020

M.HACI

M.HACI

CONSENT

10.02.2020

M.HACI

M.HACI

CONSENT

10.02.2020

M.HACI

M.HACI

CONSENT

10.02.2020

M.HACI

M.HACI

CONSENT

10.02.2020

M.HACI

M.HACI

CONSENT

10.02.2020

M.HACI

M.HACI

CONSENT

10.02.2020

M.HACI

M.HACI

CONSENT

10.02.2020

M.HACI

M.HACI

CONSENT

10.02.2020

M.HACI

M.HACI

CONSENT

10.02.2020

M.HACI

M.HACI

CONSENT

10.02.2020

M.HACI

M.HACI

CONSENT

10.02.2020

M.HACI

M.HACI

CONSENT

10.02.2020

M.HACI

M.HACI

CONSENT

10.02.2020

M.HACI

M.HACI

CONSENT

10.02.2020

M.HACI

M.HACI

CONSENT

10.02.2020

M.HACI

M.HACI

CONSENT

10.02.2020

M.HACI

M.HACI

CONSENT

10.02.2020

M.HACI

M.HACI

CONSENT

10.02.2020

M.HACI

M.HACI

CONSENT

10.02.2020

M.HACI

M.HACI

CONSENT

10.02.2020

M.HACI

M.HACI

CONSENT

10.02.2020

M.HACI

M.HACI

CONSENT

10.02.2020

M.HACI

M.HACI

CONSENT

10.02.2020

M.HACI

M.HACI

CONSENT

10.02.2020

M.HACI

M.HACI

CONSENT

10.02.2020

M.HACI

M.HACI

CONSENT

10.02.2020

M.HACI

M.HACI

CONSENT

10.02.2020

M.HACI

M.HACI

CONSENT

10.02.2020

M.HACI

M.HACI

CONSENT

10.02.2020

M.HACI

M.HACI

CONSENT

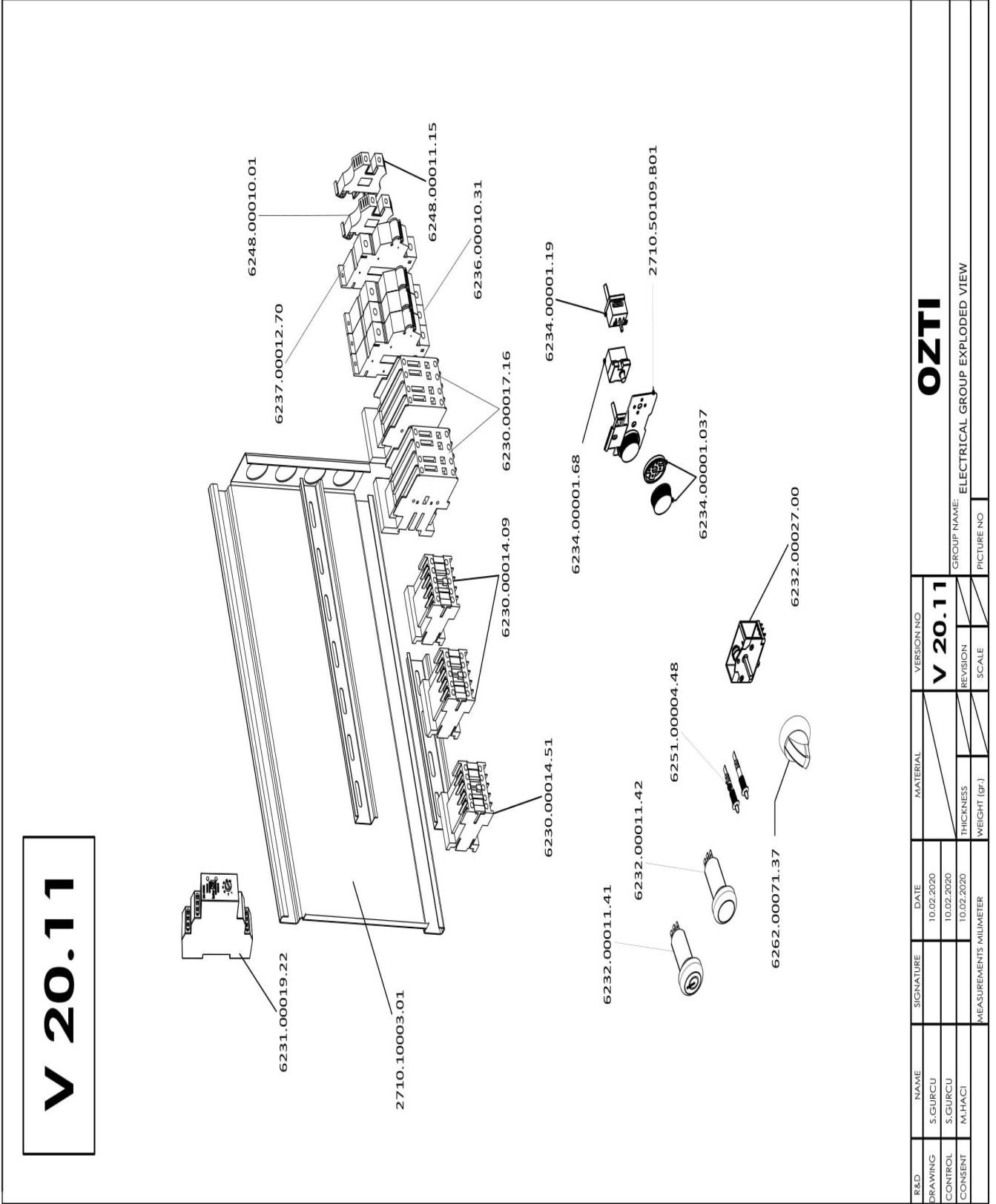

**OZTI**

GROUP NAME: ELECTRICAL GROUP EXPLODED VIEW  
PICTURE NO:

R&D	NAME	SIGNATURE	DATE	MATERIAL	VERSION NO	
					VERSION NO	REVISION
DRAWING	S.GURCU		10.02.2020		V 20.11	
CONTROL	S.GURCU		10.02.2020	THICKNESS		
CONSENT	M.HACI		10.02.2020	WEIGHT (gr.)	SCALE	
MEASUREMENTS IN MILLIMETER						